

Parks Committee Agenda
Jefferson County

Date: Thursday June 27, 2024

Time: 10:30 a.m.

Room: Courthouse C1021

Committee Members: Joan Callan, Walt Christensen, Anthony Gulig, Cassie Richardson, Meg Turville-Heitz

Videoconference OR

Jefferson County Courthouse Room C1021

311 South Center Ave.

Jefferson, WI 53549

Join Zoom Meeting

<https://us06web.zoom.us/j/85374488469?pwd=QpxOjoSW7Jy97wqOMjfaqcX6fgEtYR.1>

Meeting ID: 853 7448 8469

Dial by your location

Passcode: 369458

+1 312 626 6799 US (Chicago)

1. Call to order
2. Roll call (establish a quorum)
3. Certification of compliance with the Open Meetings Law
4. Approval of the agenda
5. Approval of Parks Committee Minutes for May 23rd, 2024
6. Communications
7. Public Comment (Members of the public who wish to address the Committee on specific agenda items must register their request at this time)
8. Discussion and Possible Action on County Parks Shop parking and access re-configuration
9. Discussion on WE Energies License Addendum #4 Culvert
10. Update and Discussion on Interurban Trail Project
11. Update and Discussion on Flood Mitigation Property Violations
12. Field Staff Project Updates
13. Admin Staff Project Updates
14. Discussion on Parks 2024 Budget
15. Discussion on Agenda Items for the Next Meeting
16. Next Scheduled Meetings per the 2024 Proposed Meeting Schedule (4th Thursday, Monthly)
 - July 25, 2024
 - August 22, 2024
 - September 26, 2024
17. Adjourn

A Quorum of any Jefferson County Committee, Board, Commission or other body, including the Jefferson County Board of Supervisors, may be present at this meeting.

Individuals requiring special accommodations for attendance at this meeting should contact the County Administrator 24 hours prior to the meeting at 920-674-7101 so appropriate arrangements can be made.

Jefferson County Parks Committee Minutes

Thursday, May 23, 2024

Time: 9:00 a.m.

Room: Courthouse C1021

Join Zoom Meeting <https://us06web.zoom.us/j/81764690750?pwd=TG9nUERZcnNRRVRoeHp5eHVZMVV1dz09>**1. Call to order**

Wiesmann called the meeting to order at 9:00 am

2. Roll call (establish a quorum)

Present: Callan, Christensen, Gulig, Turville-Heitz, Richardson (9:02 am)

Absent:

Remote:

Staff Present: Wiesmann, Klement, Wehmeier

Staff Remote: Udovich

Others: Robin Untz, Historic Sites Preservation Council/Town of Lake Mills; Tom Buechel (remote)

3. Certification of compliance with the Open Meetings Law

Staff confirmed compliance.

4. Approval of the Agenda**5. Administration Approval of Parks Committee Minutes for May 2, 2024**

Gulig/Turville motion to approve the Minutes for May 2, 2024. Motion passes 4/0.

6. Communications

- Brew with A View to be held next week (May 30) at Korth Park.
- Light up the Night community bike ride, hosted by Jefferson County Parks, Partners, and Volunteers will be on September 7, 2024. This will be a night ride, with bicycles decorated in lights, for the community. Free helmets will be offered to children who pre-register.

7. Public Comment (Members of the public who wish to address the Committee on specific agenda items must register their request at this time)

N/A

8. Discussion and Possible Action on Lower Rock Lake Park Lane Boat Launch re-configuration, Town of Lake Mills Wiesmann – TOLM refigure to increase/improve access and launch service. In-kind project, goal is re-use product.

Corey (engineer) noted that the launch concrete panels are uneven, there is metal banding that is separating, and the steel pilings are damaged – the goal is to refresh existing components. Trying to minimize impacts to the lake. Key components to re-use: large concrete abutments, trying to minimize grading in the lake. Would like to improve efficiency of the launch. Space is limited for trailer unloading/loading/turning. Widening space not an option. Lengthening the pavement 20' north (into the park proper) improves the ability to load/unload and enables a safer process. Difficult on a windy day to have an angled launch with prevailing wind, waves. Changing the grading underwater is also not feasible.

Tom Buechel (Town of Lake Mills, Chair) noted that the concern is pedestrian safety, and user safety.

Gulig shared concerns about site lines with car/truck mirrors backing into the launch and mirrors not in-line, suggesting that this proposal will not solve the problem.

Turville questioned possible ground compaction around trees.

Corey (engineer) noted that they will use asphalt, boulders, tree protection, dripline, and minimize impacts to trees.

Christensen questioned restricting vehicle/trailer length.

Buechel stressed the crew is trying to minimize costs.

Wiesmann stated that the County owns the parking lot (north of Hwy B), and the Lower Rock Lake Park space

(south of Hwy B) and, the Town of Lake Mills owns the boat launch. The Township keeps launch fees (restricted to launch improvements).

Richardson/Gulig motion to allow the Town of Lake Mills to redesign the boat launch, and to allow the launch/vehicle-trailer area to extend an additional 20 feet north into the Lower Rock Lake Park. Motion passes 5/0.

9. Discussion on Parks 2024 Budget

No discussion/no action taken.

10. Discussion on Agenda Items for the Next Meeting

Tour follow-up

ATV/UTV County Map

11. Next Scheduled Meetings per the 2024 Proposed Meeting Schedule (4th Thursday, Monthly @ 10:30 AM)

- June 27, 2024
- July 25, 2024
- August 22, 2024
- September 26, 2024

12. Jefferson County Park Tour:

Committee members toured the following sites. No action taken.

- Interurban Bike Trail County Hwy F Bridge Construction Site
- Kanow County Park
- Korth County Park Connector Trail
- Trieloff Property

13. Adjourn

Callan/Turville-Heights motion to adjourn at 11:40. Motion passes 3/0.

Respectfully Submitted,

Mary S. Truman

Adv. Program Asst., Parks

June 2024

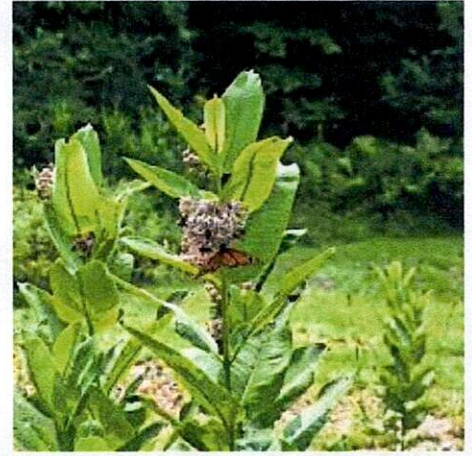

To Whom It May Concern,

I would like to thank you so much for carefully mowing the bike paths from Hwy 18 to Old Hwy 26 this June. It was great to see that the mowing team left a section next to the fence line untouched. This area, in the past, has been where many milkweed plants have sprouted. The plants are just now at the stages for the Monarch Butterflies to lay their eggs—so leaving them untouched is so **important!**

Thanks again for all you do, and your attention to the areas that have milkweed growing!

Sincerely,

A Bike Path User / Educator



ANNOUNCING...

#6

RLIA LEGENDARY LEARNING NIGHTS 2024

Enjoy a night out and learn about impacts to our waters, the amazing water critters you almost don't see, & beneficial bugs! Take a guided stroll, exploring Korth Park's restoration. All events are from 6:30 to 7:30 pm

6/19 (Wed) Balancing Competing Demands / Thomas Steinbach, Oconomowoc Watershed Protection Program.

Location: Trinity Lutheran, 346 W Pine St. Lake Mills

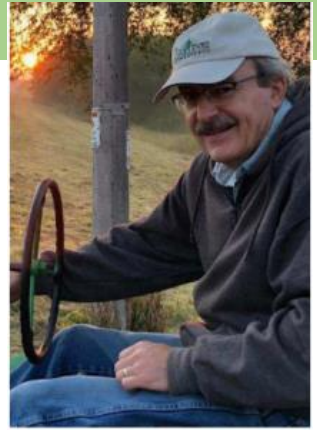

7/9 (Tues) Hidden Water Creatures--The (almost) Unseen / Emily Heald, Rivers Educator UW Madison Extension. Location: The Pharmacy, Upstairs, 203 N Main St. Lake Mills

7/17 (Wed) Prairie Walk & Restoration Plans Jefferson Cty Parks Staff. Location: Korth Park Upper Pavilion, W8390 Korth Lane Lake Mills



8/15 (Thurs) Don't Let it Bug You!! / Paul Liesch, Director of Univ of Wisconsin-Madison Insect Diagnostic Lab. Location: Trinity Lutheran, 346 W Pine St. Lake Mills



FREE ADMISSION! NO REGISTRATION REQUIRED.

Sponsored by Rock Lake Improvement Association & Jefferson County Parks

For more information: rocklake.org/legendarylearning/

The Jefferson County Parks Department and The Jefferson County Health Department Present:



LIGHT UP THE NIGHT BIKE RIDE



Join us for an afterhours FREE Family Fun ride! Located on the Glacial River Bike Trail. We're giving away FREE bike helmets to the first 75 kids to sign up, 200 FREE event t-shirts and bicycle lights. Help us promote bicycle safety and the amazing bicycle assets our community has to offer!

**SEPTEMBER 7
MEET-UP: 6:30PM
AT 1309 N. HIGH ST(U-HAUL)
FORT ATKINSON**

SCAN HERE TO REGISTER!



THANK YOU TO OUR SPONSORS!

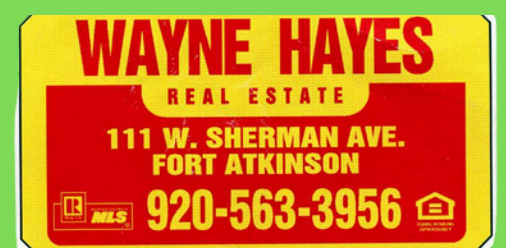

For more information, visit our site: www.jeffersoncountywi.gov/park

BREW WITH A VIEW				
	2021	2022	2023	2024
May	\$ -	\$4,687.00	\$ 4,543.00	\$ 4,533.00
June	\$ 4,952.50	\$ 4,900.50	\$ 4,401.00	
July	\$ 6,491.75	\$ 5,598.50	\$ 3,541.00	
August	\$ 4,464.50	\$ 3,744.00	\$ 3,850.00	
Total	\$ 15,908.75	\$ 18,930.00	\$ 16,335.00	\$ 4,533.00
Average	\$ 5,302.92	\$4,732.50	\$ 4,083.75	\$ 4,533.00

NRF Deposit

50/50 RAFFLE & EVENT DONATIONS				
	2021	2022	2023	2024
May	\$ -	\$ -	\$ 1,122.00	\$ 767.00
June	\$ 134.00	\$ 782.00	\$ 633.00	
July	\$ 1,441.00	\$ 869.00	\$ 1,061.00	
August	\$ 775.00	\$ 763.00	\$ 1,098.00	
	\$ 2,350.00	\$ 2,414.00	\$ 3,914.00	\$ 767.00

Anticipated utilization of funds raised from 2024 Brew with a View events: Funds from the first 50/50 raffle will go towards the September 2024 Light Up the Night Bike Ride on the Glacial River Trail and will help fund free bike helmets for kids and hi-vis shirts for the first 200 sign-ups to the event. The remainder of funds raised from the 2024 Brew with a View events and 50/50 raffles will go towards repairs to the Korth Park Connector Trail and be used as potential match for RTP and Stewardship Grants that Jefferson County Parks Submitted in May of 2024.



PROJECT NO.:	JF 154
DRAWING FILE:	JF 154 CONTRACT B SHEETL09
DRAWN BY:	N.J.D.
CHECKED BY:	B.R.B.
DATE:	6-17-24
REVISIONS:	
SCALE:	

REMS # XXXXXX
Land Interest

ADDENDUM # 4
JEFFERSON COUNTY – BRIDGE CONSTRUCTION

THIS LICENSE ADDENDUM #4 (this “Addendum”) is made as of the Effective Date set forth above by and between Wisconsin Electric Power Company, a Wisconsin corporation, doing business as We Energies, (hereinafter “Licensor”) and Jefferson County (hereinafter “Licensee”).

WITNESSETH:

BY LICENSE AGREEMENT, entered into on the 18th day of February, 2015 by and between said Licensor and Licensee, wherein Licensor granted Licensee the right, permission and authority, to develop and use a part of Licensor’s fee owned right of way land for the purpose of hiking, biking and cross-country skiing and other similar non-motorized recreational uses for use by the general public, and

WHEREAS, Licensor and Licensee entered into an Amendment License at the request of the Wisconsin Department of Transportation. Licensee qualifies and will be awarded significant grant money to finish construction of the trail between River Road and C.T.H. “F”. The request is to extend the duration of the existing license for an additional 15 years.

WHEREAS, Licensor and Licensee entered into an Addendum #1 dated the 4th of May, 2018 which Licensee was granted the right, permission and authority to construct and install a pedestrian bridge over the Rock River.

WHEREAS, Licensor and Licensee entered into an Addendum #2 dated the 4th of December, 2019 which Licensee was granted the right, permission and authority to construct wood fencing around the right of way due to steep grades off the trail.

WHERE AS, Licensor and Licensee entered into an Addendum #3 dated the 19th of May, 2022 which Licensee was granted the right, permission and authority to construct a new culvert and rebuild two previously removed culverts by We Energies and where Licensee has taken sole ownership of culverts and will maintain, repair remove and replace them as needed.

WHERE AS, Licensee has requested Licensor permit construction and installation of a pedestrian bridge over the Rock River, 0.6 miles east of CTH F being more particularly described as:

A portion of Company’s right of way land in the Northwest ¼ of the Southeast ¼, Section 27, Township 8 North, Range 16 East in the Town of Ixonia, Jefferson County, Wisconsin (hereinafter “Lands”). The location of the land and bridge is shown on the attached map marked Exhibit “A” and made a part hereof.

NOW, THEREFORE, for and in consideration of covenants, conditions and agreements hereinafter contained and for the mutual benefit of Licensor and Licensee, both parties hereby agree to the following:

1. Licensor hereby agrees to make part of said License those additional right of way as lands referenced in said Exhibit "A". Licensee will construct bridge based off the plans submitted and dated and accepted by Jefferson County January 10, 2024.
2. Licensee agrees that all work done in proximity of any electric line facilities shall be performed in conformance with the provisions and requirements of all applicable laws, rules and regulations, including without limitation, all laws, rules and regulations such as O.S.H.A. Safety and Health Regulations of Construction dealing with safe work practices and the operation of equipment near electrical lines and equipment, and the provisions of the Wisconsin State Electrical Code and any amendments thereto. A minimum of a 12' clearance from all overhead electric facilities must be maintained at all times. A 10' clearance from any underground electric or gas facilities must be maintained at all times. Note: O.S.H.A. Rules may require greater distances than Licensor's minimum clearances listed depending on type of work being done. Please follow O.S.H.A. when it is greater than Licensor's minimum clearances.
3. Licensee agrees to contact "Digger's Hotline" at (800) 242-8511 at least five (5) days prior to any work, excavation or construction of Trail (as described in License Agreement dated February 18th, 2015) or bridge, as permitted herein, in order to determine the location of any electric, telephone, gas, or any other utility facilities within the Lands of Licensor and the applicable clearance requirements for work performed in proximity to such facilities.
4. Licensee agrees to contact John Harvie (414) 944-5720 or such other person or phone number as Licensor may from time to time designate, within the specified time limits to inform him about the following occurrences:
 - a) At least seven (7) days prior to the commencement of the project herein permitted or future approved projects.
 - b) Within seven (7) calendar days after the termination of the License with a plan for restoration in accordance with the requirements of Section 15 of License.
 - c) Within seven (7) calendar days after the restoration has been completed.
 - d) Within seven (7) calendar days after a lapse of one (1) year since Licensee accepted this License Addendum if the project herein permitted has not been undertaken by such date.
5. No stockpiling or staging of equipment or materials within the Lands is permitted at any time. Unobstructed access of the Lands and utility equipment must be maintained at all times.
6. Licensee will place proper safety signs and barriers to prevent public access to the bridge area and relocate trail users away from area during construction.
7. Licensee will install proper signage after construction, along and around the bridge area, to indicate any safety or weight restrictions for vehicles such as service and maintenance trucks, ambulances, fire trucks, etc.
8. If Licensee requests to alter or change the approved plans or adds any work to that already approved, requested changes and additions must be submitted to Licensor for further review or approval.
9. Licensee agrees that any piers, supports, or other items used in the water or on the land for construction purposes will be the sole responsibility of the Licensee.
10. Licensor is not responsible for the integrity, condition and strength of the existing foundations. Licensee hired an independent engineering firm to provide them information on the condition. Licensee determined they are attaching the bridge to original foundations. Licensee is installing

the bridge on the foundations at their own risk. Installation, replacement, maintenance and removal of original foundations and new bridge are Licensee's responsibility. Licensor does not require bridge or foundations and does not need them for access or utility purposes. Once bridge is installed on original foundations, the foundations are Grantee's sole cost and responsibility to install, maintain, remove and replace foundations.

11. All permits for working in waterways: ACOE, Wisconsin DNR and any other permits from the County, or local municipality or any other entity the Licensee is required to obtain and provide a copy to the Licensor prior to construction.
12. Licensor must review plans prior to installation for final approval. Please allow a minimum of 30 days for review of plans before construction.
13. This License Addendum #4 shall be deemed a part of and incorporated into the License. All other terms, conditions and provisions of the License shall remain in full force and effect.

[SIGNATURE PAGE FOLLOWS]

This Addendum may be executed in multiple counterparts, each of which shall be deemed an original Agreement and both of which shall constitute one and the same Agreement. The counterparts of this Agreement may be executed and delivered by facsimile or other electronic signature (including portable document format) by either of the parties and the receiving party may rely on the receipt of such document so executed and delivered electronically or by facsimile as if the original had been received.
[Signature information below]

This Agreement is hereby granted under the terms and conditions set forth hereinabove.

Licensee:

By: _____ Dated: _____
(Authorized Signature)
Benjamin Wehmeier
(Print Name)
County Administrator
(Title)

Choose a type:

Wisconsin Electric Power Company, a Wisconsin corporation, doing business as We Energies

By: WEC Business Services LLC, Its Affiliate and Agent

Signature: _____
Tonya M. Peters, Manager of Property Management

EXHIBIT "A"

Rock River Pedestrian Bridge Overview



EXHIBIT "A" continued

Contour Map

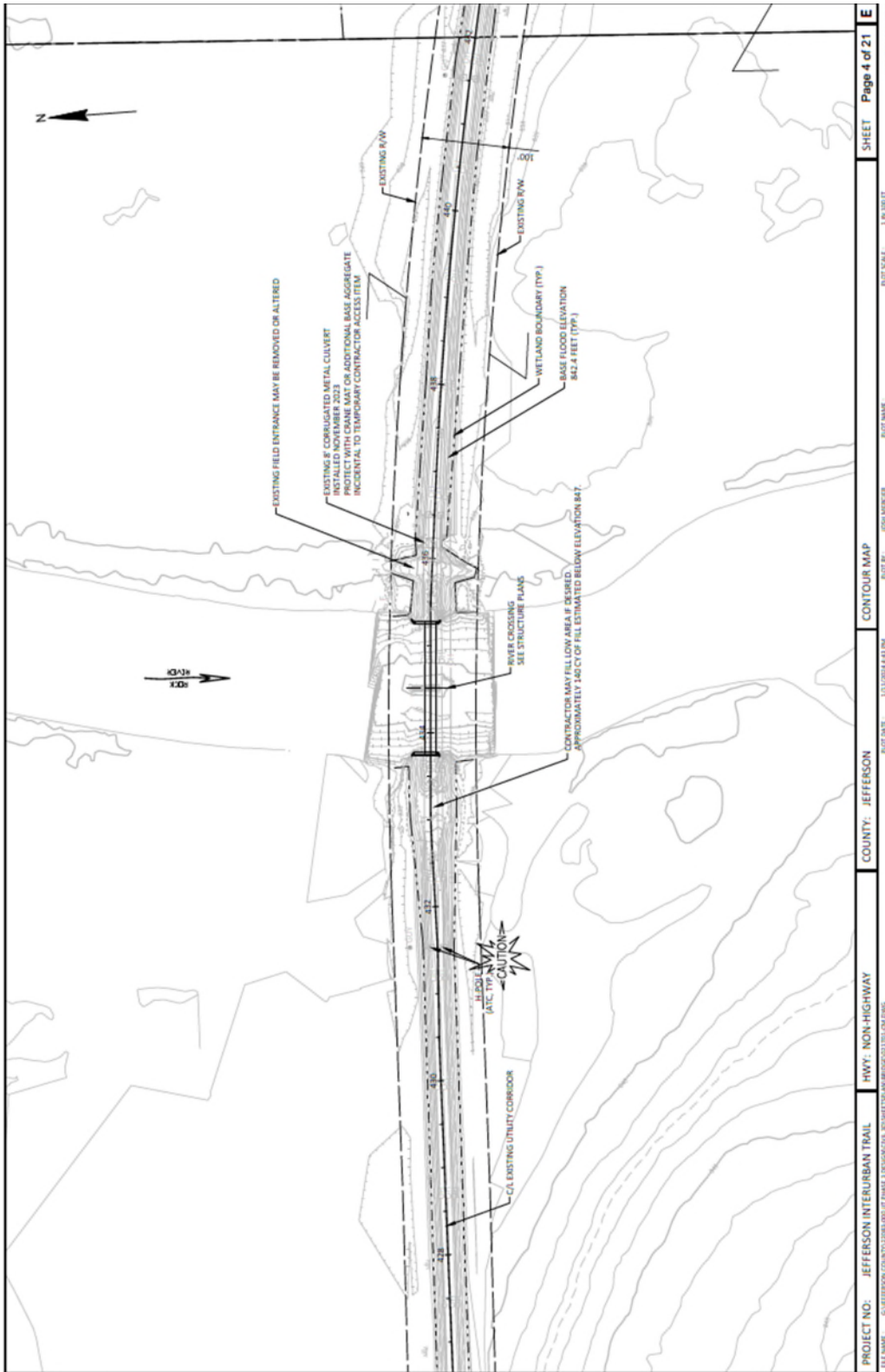

ORG DESC	ORIGINAL	TRANSFERRED	REVISED	ACTUALS	ENCUMBRANCES	AVAILABLE
Altpeter County Park	8.00	-	8.00	7.26	-	0.49
Bike Trails	450,127.00	319,204.00	769,331.00	20,727.77	-	30,010.83
Blackhawk Island Fishing Wha	-	-	-	-	-	-
Boat Launches	-	-	-	1,706.71	-	(1,706.71)
Burnt Village Hist Site & Lauc	15.00	15,000.00	15,015.00	13.86	-	(9,829.94)
Cappies Landing	14.00	-	14.00	470.15	-	(456.50)
Carlin Weld Park Trust	4,646.00	(194.00)	4,452.00	246.20	-	4,206.08
Carnes Park Development	224,388.00	24,715.00	249,104.00	6,666.20	-	242,437.85
Carol Liddle Fund	-	64,527.00	64,527.00	-	-	64,526.63
Cold Spring Creamery	37.00	-	37.00	34.10	-	2.45
Crawfish River Park	-	-	-	-	-	-
Dog Park	94,677.00	(31,449.00)	63,229.00	27,522.58	-	35,706.65
Flood Mitigation Prop Maint	-	35,000.00	35,000.00	2,504.76	-	32,495.24
Garman Nature Preserve	126,832.00	17,214.00	144,045.00	19,959.49	-	124,085.97
Glacial Heritage Development	-	14,762.00	14,762.00	-	-	14,762.42
Grounds Keeping	91,794.00	-	91,794.00	14,806.05	-	76,987.82
Hwy 16 Landing	-	-	-	-	-	-
Hwy K Wayside	-	-	-	-	-	-
Indian Mounds Park	10.00	-	10.00	9.68	-	0.67
Joy County Park	2.00	-	2.00	2.09	-	0.20
Kanow County Park	106.00	-	106.00	195.48	-	(89.20)
Korth Park Development	445.00	147,242.00	147,687.00	3,837.06	-	143,850.63
Parks Building	25,818.00	-	25,818.00	9,998.40	-	15,819.43
Parks Department	1,098,506.00	-	1,098,506.00	550,612.34	-	468,828.07
Pohlman County Park	81.00	-	81.00	75.79	-	5.50
Rock Lake County Park	259.00	-	259.00	944.17	-	(685.35)
Rock River County Park	70.00	-	70.00	65.56	-	4.76
Rome Pond County Park	68.00	-	68.00	62.92	-	4.63
Snowmobile Trails	160,395.00	-	160,395.00	65,755.22	-	94,639.43
Welcome Travelers County Pa	82.00	-	82.00	76.01	-	5.56
	2,278,380.00	606,021.00	2,884,402.00	726,299.85	-	1,335,613.61

EXPENSES 06.24.24

ORG DESC	ORIGINAL	TRANSFERRED	REVISED	ACTUALS	ENCUMBRANCES	AVAILABLE
Altpeter County Park	(8.00)	-	(8.00)	(3.25)	-	(4.50)
Bike Trails	(450,127.00)	-	(450,127.00)	(252.90)	-	(449,874.01)
Blackhawk Island Fishing Wh	-	-	-	-	-	-
Boat Launches	-	-	-	(491.88)	-	491.88
Burnt Village Hist Site & Land	(15.00)	-	(15.00)	(6.20)	-	(8.72)
Cappies Landing	(14.00)	-	(14.00)	(43.61)	-	29.96
Carlin Weld Park Trust	(122.00)	-	(122.00)	(825.74)	-	703.57
Carnes Park Development	(17,444.00)	-	(17,444.00)	(10,843.77)	-	(6,600.41)
Carol Liddle Fund	-	-	-	(2,087.64)	-	2,087.64
Cold Spring Creamery	(37.00)	-	(37.00)	(15.25)	-	(21.30)
Crawfish River Park	-	-	-	-	-	-
Dog Park	(53,164.00)	-	(53,164.00)	(30,528.37)	-	(22,636.04)
Flood Mitigation Prop Maint	-	-	-	-	-	-
Garman Nature Preserve	(120,000.00)	-	(120,000.00)	(361,922.40)	-	241,922.40
Glacial Heritage Developmen	-	-	-	-	-	-
Grounds Keeping	(91,793.00)	-	(91,793.00)	-	-	(91,793.87)
Hwy 16 Landing	-	-	-	-	-	-
Hwy K Wayside	-	-	-	-	-	-
Indian Mounds Park	(10.00)	-	(10.00)	(4.30)	-	(6.05)
Joy County Park	(2.00)	-	(2.00)	(0.95)	-	(1.34)
Kanow County Park	(106.00)	-	(106.00)	(168.66)	-	62.38
Korth Park Development	(445.00)	-	(445.00)	(15,024.11)	-	14,578.90
Parks Building	(25,818.00)	-	(25,818.00)	(10,757.45)	-	(15,060.38)
Parks Department	(1,090,367.00)	-	(1,090,367.00)	(458,121.93)	-	(632,245.42)
Pohlman County Park	(81.00)	-	(81.00)	(76.50)	-	(4.79)
Rock Lake County Park	(259.00)	-	(259.00)	(1,432.21)	-	1,173.39
Rock River County Park	(70.00)	-	(70.00)	(188.21)	-	117.89
Rome Pond County Park	(68.00)	-	(68.00)	(28.15)	-	(39.40)
Snowmobile Trails	(160,395.00)	-	(160,395.00)	(239.45)	-	(160,155.20)
Welcome Travelers County P	(82.00)	-	(82.00)	(128.78)	-	47.21
	(2,010,427.00)	-	(2,010,427.00)	(893,191.71)	-	(1,117,236.21)

REVENUE 06.24.24